

# WILLCOX



## 109 The Plateau Ormeau Hills QLD

4 2 4

Basking in the peace and privacy of a grassed 9,825sqm holding with a panoramic bushland vista, this is a family haven of exceptional calibre. Capturing valley and water views all the way to Jumpinpin, the main lounge, dining and family areas are fluid, with high ceilings enhancing the sun-soaked layout and an easy flow to a covered alfresco and pool set against a magnificent backdrop of endless trees.

Also on the property is a three bay shed with a workshop in one bay while the other two bays have been converted into an entertainment area that has been lined and insulated. Fittings include ceiling fans, two tv outlets and a dedicated 15 Amp circuit.

Exceptionally private with environmental reserve surrounds and set on the highest point on The Plateau, this lifestyle

**Price** : \$ 955,000  
**Land Size** : 9825 sqm  
**View** : <https://www.willcoxestateagents.com.au/sale/qld/logan/ormeau-hills/residential/acreage-semirural/5866024>



**Jesse Willcox**  
0403 039 167

Internal 281m<sup>2</sup> External 101m<sup>2</sup> Total 382m<sup>2</sup>

# 109 The Plateau, Ormeau Hills



4/5 x 2 x 4 x

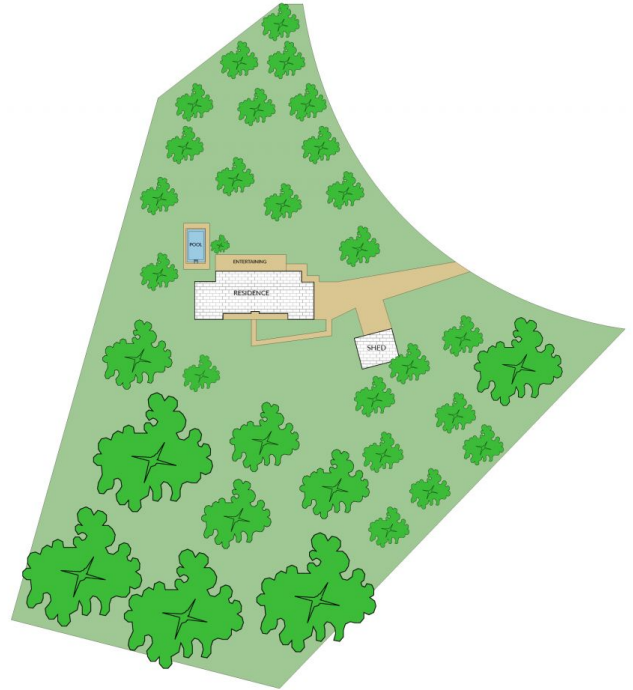

**NOTE:** Every precaution has been taken to verify the accuracy of the above details. However, prospective purchasers are advised to make their own enquiries.