

WILLCOX

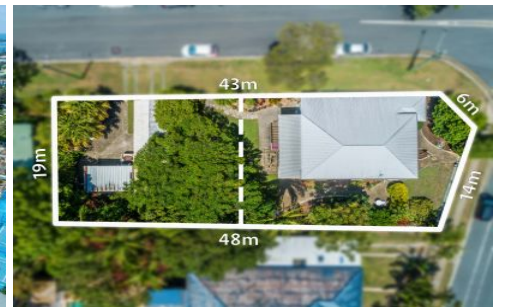

23 Brooke Avenue Southport QLD

3 1 1

Elevated original Queenslander, held by same owners since 1959, occupying a coveted double block on a corner position. Renovate to create your ultimate Queensland dream, land bank and rent out as is for the years to come or sub-divide this 873sqm double block (subject to council approval), the opportunities are only limited by your imagination.

Price : \$ 716,000
Land Size : 873 sqm
View : <https://www.willcoxestateagents.com.au/sale/qld/gold-coast/southport/residential/house/5865987>



Defying current market conditions, the Chirn Park precinct is in very high demand with families and investors alike, make sure you don't miss out. Inspect this weekend as this property will be sold under the hammer, if not prior.

? 873sqm block - suitable for separate blocks (subject to council approval)

? Dual frontage - 14m frontage to popular Brooke Avenue, 43m to Lionel Avenue

<https://www.willcoxestateagents.com.au>

Internal 295m²

3 x  1.5 x 

23 Brooke Avenue, **Southport**

NORTH

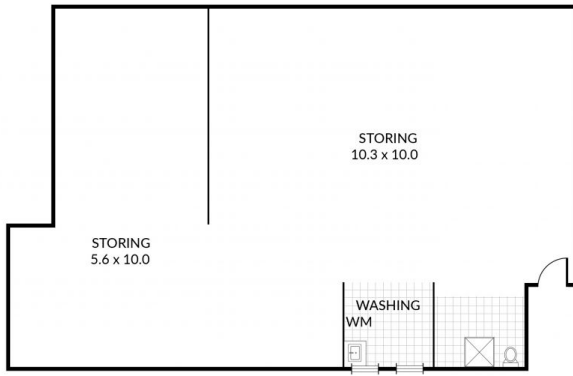

GROUND FLOOR

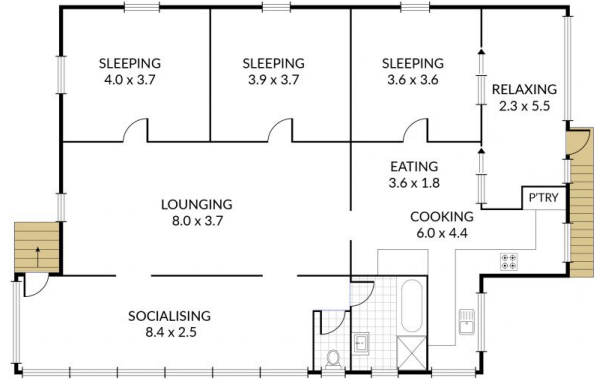

FIRST FLOOR

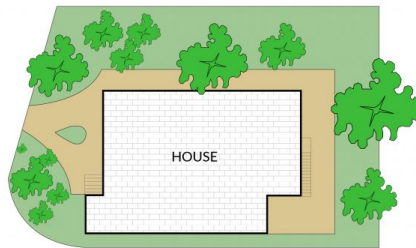

NOTE: Every precaution has been taken to verify the accuracy of the above details. However, prospective purchasers are advised to make their own enquiries.